

File name \\UK\WSPGROUP\COM\CENTRAL\DATA\PROJECTS\70062980\WSP-GEN-IR-DR-CH-1200-1201 (P03) (TEMP TRGS) DWG, printed on 12 October 2022 16:22:46, by Davey, Philip

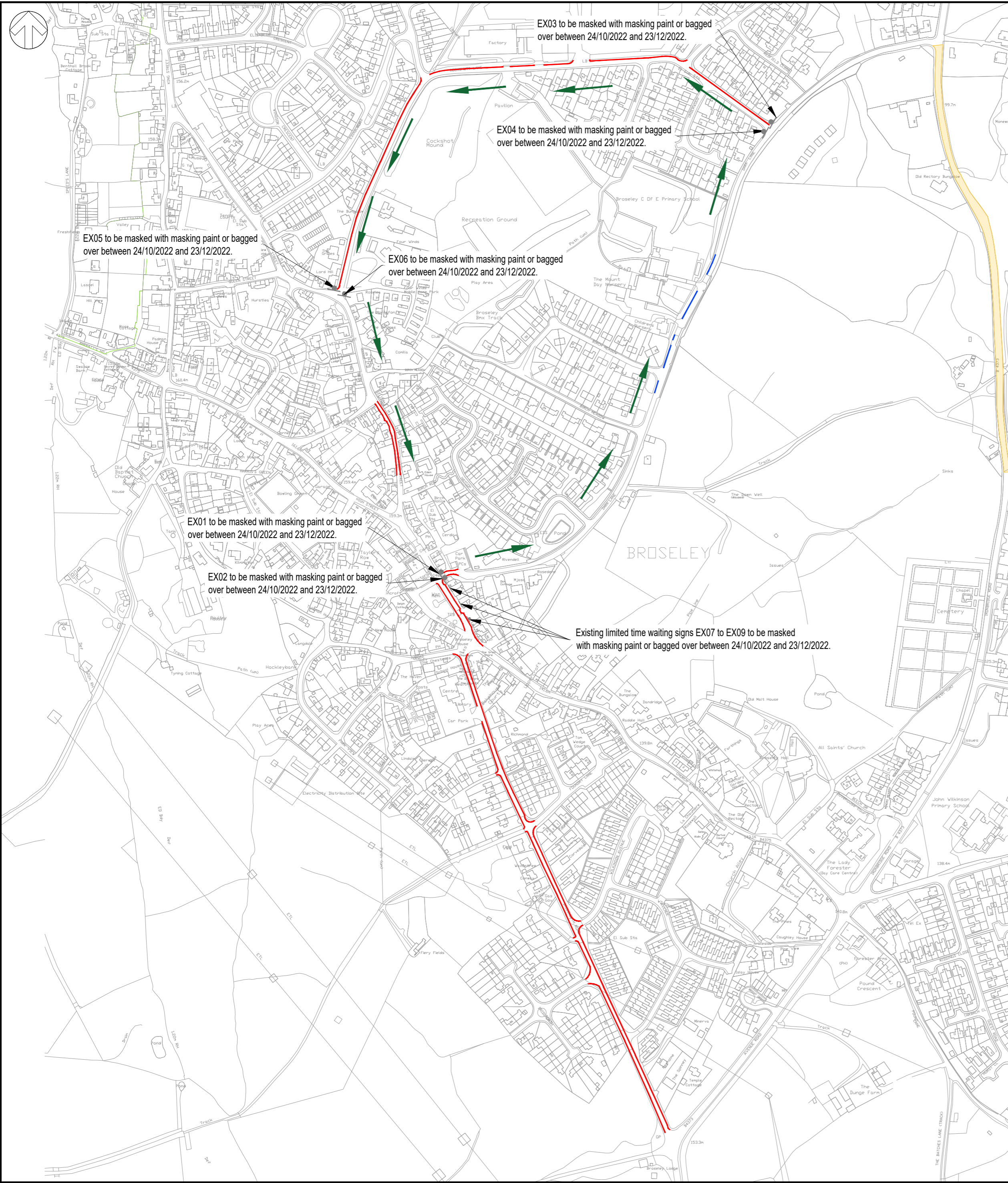

Key

- Water filled barriers to be placed on the east side of Dark Lane approximately 0.5 metres from the kerb edge, over the length of the SCHOOL KEEP CLEAR markings (for traffic calming purposes). All vehicle accesses and pedestrian crossing points to be kept clear. From 24/10/2022 to 23/12/2022
- Location of temporary traffic regulation orders. No waiting at any time. From 24/10/2022 to 23/12/2022
- ← Arrows indicating direction of traffic flow around the proposed one-way system. From 24/10/2022 to 23/12/2022
- Location of Ironbridge Road closure. From 31/10/2022 to 16/12/2022
- Existing traffic sign post and sign / wall mounted sign plate.

Temporary Traffic Regulation Orders

1. **Road Closure.**
Ironbridge Road.
 From the junction of Dark Lane and Ironbridge Rd. to the junction of Ironbridge Rd. and the road to Coneybury Farm and Woodhouse Farm (U6817/ 10).
 Between 31/10/2022 and 16/12/2022.
 2. **Parking bay suspension.**
High Street.
 The suspension of the 2 limited time parking bays on High St. Broseley outside Numark Chemist, Broseley News, E Davis & Sons Ironmongery and Four Paws Pets Shop & Grooming; and outside the Fish and Chip Shop, and Zengh Indian Restaurant.
 Between 24/10/2022 and 23/12/2022.
 3. **7.5 T Weight Limit suspension.**
Dark Lane and Cockshutt Lane, Broseley.
 Between 24/10/2022 and 23/12/2022.
 4. **No waiting at any time.**
Barber St. (both sides) from its junction with Duke St. for 86m.
Bridgnorth Rd. (both sides) between The Square and Avenue Rd.
Cockshutt Lane. (west side) between its junction with Duke St. and its junction with Cherrybrook Drive.
Cockshutt Lane. (north side) between its junction with Cherrybrook Drive and its junction with Dark Lane.
Dark Lane. (both sides) from its junction with High Street easterly for 25 metres.
High Street. (east side) between its junction with Dark Lane and its junction with The Square.
High Street. (west side) between its junction with Smithy Bank and its junction with The Square.
 Between 24/10/2022 and 23/12/2022
- Traffic cones to be used to prevent parking over the following lengths of road.
- Barber Street (east side)
 From its junction with Duke St. /Fox Lane to its junction with High St.
 - Barber Street (west side).
 From its junction with Duke St. /Fox Lane for 86 metres in a southerly direction.
 - Bridgnorth Road (both sides).
 Between its junction with The Square and its junction with Avenue Road.
 - Cockshutt Lane (west side).
 Between its junction with Duke St. and its junction with Cherrybrook Drive.
 - Cockshutt Lane (north side).
 Between its junction with Cherrybrook Drive and its junction with Dark Lane.
 - Dark Lane (both sides).
 From its junction with High St. for 25 metres in an easterly direction.
 - High Street (both sides).
 Between its junction with Dark Lane and its junction with the Square.
 - The Square (east side).
 Between its junction with High St. and its junction with Church St.
5. **Temporary one-way order.**
Barber Street.
 Southerly from its junction with Duke Street to its junction with High St.
Cockshutt Lane.
 First westerly then southerly from its junction with Dark Lane to its junction with Duke St.
Dark Lane.
 Northerly from its junction with High St. to its junction Cockshutt Lane.
Duke Street.
 Southerly from its junction with Cockshutt Lane to its junction with Barber St.
High Street.
 Southerly from its junction with Barber St. to its junction with Dark Lane.
 Between 24/10/2022 and 23/12/2022.
 6. **Suspension of single yellow line no waiting 8am to 6pm restriction.**
Barber Street (north-west side). From its junction with Duke St. for a distance of 56 metres in a southerly direction.
 Between 24/10/2022 and 23/12/2022

DO NOT SCALE

© Crown copyright and database rights 2022 OS 100049049. You are permitted to use this data solely to enable you to respond to, or interact with, the organisation that provided you with the data. You are not permitted to copy, sub-licence, distribute or sell any of this data to third parties in any form.

Notes.

7.5 Tonne weight restriction signs and supplementary plates to be masked with masking paint or bagged over at the following locations between 24/10/2022 and 23/12/2022.

EX01 & EX02 Dark Lane junction with High Street (B4375) (x 2).

EX03 & EX04 Dark Lane junction with Ironbridge Road (B4373) (x 2).

EX05 & EX06 Cockshutt Lane junction with Duke Street (x 2).

Suspension of limited waiting bays
 The limited time waiting bays on High Street between its junction with Dark Lane and its junction with The Square require the three sign plates EX07, EX08 and EX09 to be masked with masking paint or bagged over between 24/10/2022 and 23/12/2022.

REV	DATE	BY	DESCRIPTION	CHK	APP
P03	11/10/2022	PD	RESTRICTIONS UPDATED	KH	PD
P02	05/09/2022	PD	DATES REVISED	KH	PD
P01	23/08/2022	PD	FIRST ISSUE	KH	PD

DRAWING STATUS: **S2 - FOR INFORMATION**



2nd Floor Shirehall, Abbey Foregate, Shrewsbury, SY2 6ND, UK
 T+ 44 (0) 1743 501060
 wsp.com



PROJECT: **B4373 Ironbridge Road, Broseley, Land Slip**

TITLE: **Temporary Traffic Regulation Orders**

SCALE @ A2: Not to Scale	CHECKED: K. Hatton	APPROVED: D. Davies
PROJECT No: 70062980	DESIGNED: P. Davey	DRAWN: P. Davey
DRAWING No: 70062980-WSP-GEN-IR-DR-CH-1200-1201		DATE: August 2022
REV: P03		

© WSP UK Ltd