

File name \\UK.WSPGROUP.COM\CENTRAL DATA\PROJECTS\700495XX\70049506 - SHROPSHIRE TRAFFIC\LTP MANAGEMENT\05 DRAWINGS\DWG\SHREWSBURY WAITING RESTRICTIONS\70058643-WSP-HSN-AS-DR-CH-034-1201 (CRESCENT LANE SHREWSBURY)2.DWG,
printed on 08 October 2019 11:21:25, by Davey, Philip

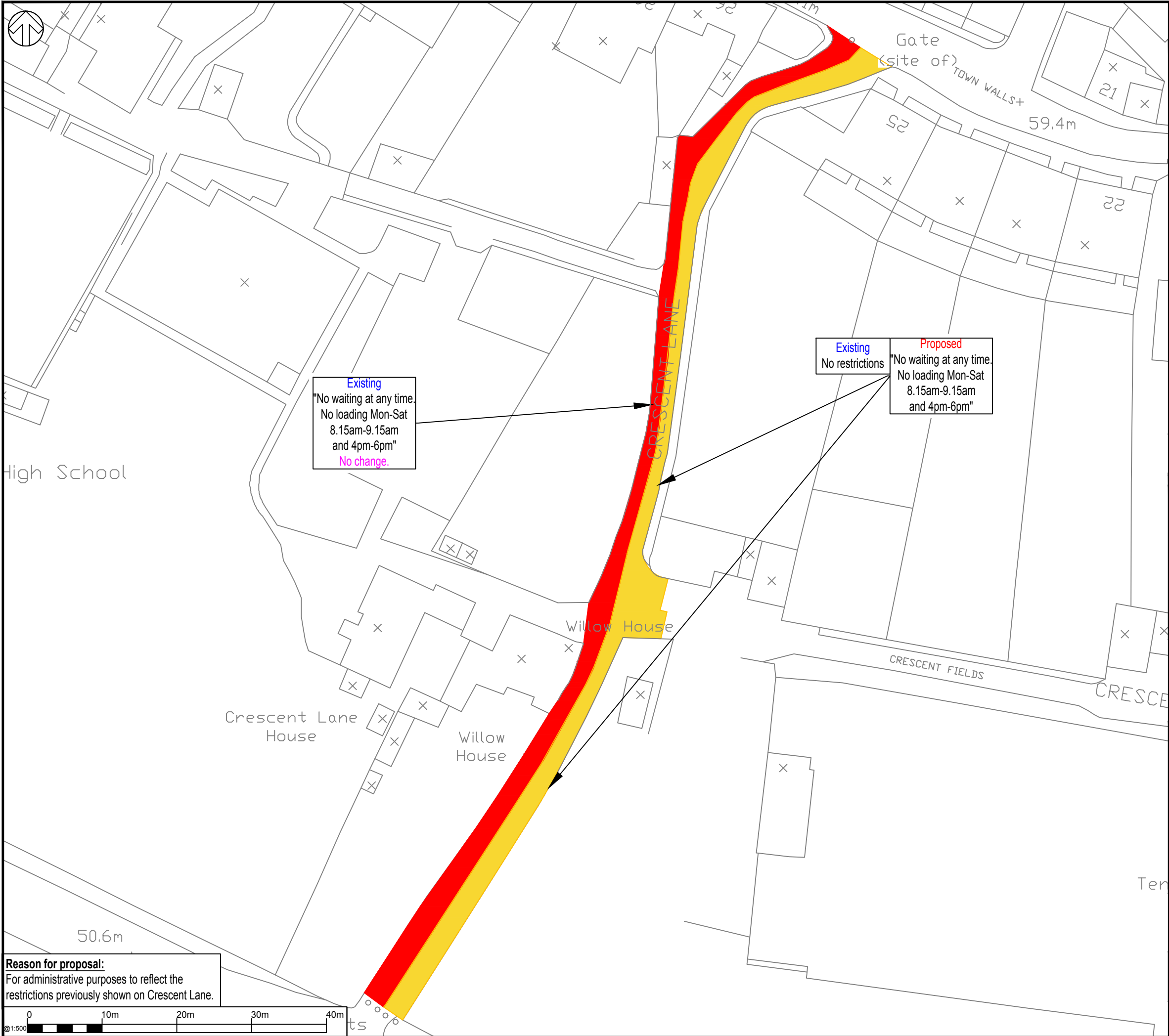

DO NOT SCALE

© Crown copyright and database rights 2019 OS 100049049. You are permitted to use this data solely to enable you to respond to, or interact with, the organisation that provided you with the data. You are not permitted to copy, sub-licence, distribute or sell any of this data to third parties in any form.

Key	
	Proposed "No waiting at any time" .
	Existing "No waiting at any time" .

Notes: This area forms part of the Town Walls area restricted parking zone and restrictions will be displayed using restricted parking zone signing.



P01	24/09/2019	PJD	FIRST ISSUE	KH	DD
REV	DATE	BY	DESCRIPTION	CHK	APP

DRAWING STATUS: S2 - FOR INFORMATION



2nd Floor Shirehall, Abbey Foregate, Shrewsbury, SY2 6ND, UK
T+ 44 (0) 1743 501060
wsp.com

CLIENT:

PROJECT:
Crescent Lane, Shrewsbury

TITLE:
Proposed waiting restrictions

SCALE @ A3: 1:500	CHECKED: K. Hatton	APPROVED: D. Davies
PROJECT No: 70058643	DESIGNED: P. Davey	DRAWN: P. Davey
DRAWING No: 70058643-WSP-HSN-AS-DR-CH-034-1201	DATE: September 2019	REV: -

© WSP UK Ltd