

© Mouchel Limited - No Reproductions Without Authority

Do not scale - Use only figured dimensions
The contractor is to check all dimensions on site and report any discrepancies to the Site Supervisor.
This drawing is to be read in conjunction with all other standard documentation.

Notes:
Finished yard to fall at 1% towards access, and include 2 no. valley's with 2.5% fall towards the channel.
Proposed surface water system designed based on unverified construction plans for the access road & attenuation pond. Survey data will need to be collected & design checked prior to construction.

Key:

- Existing Surface Water System
- Existing Surface Water Attenuation Pond
- Existing Foul Water System
- Proposed Surface Water System
- Proposed 4500 Surface Water Slot Drain
- Proposed Surface Water Swale
- Proposed Surface Water Attenuation Pond
- Proposed Foul Water System
- Proposed Rainwater Harvesting System
- Proposed Rainwater Harvesting Tank
- Proposed earth bund
- Ponds sized for 100yr storm + 30% with 5 l/sec/ha discharge
- 8 Acre Plot
- 5 Acre Plot

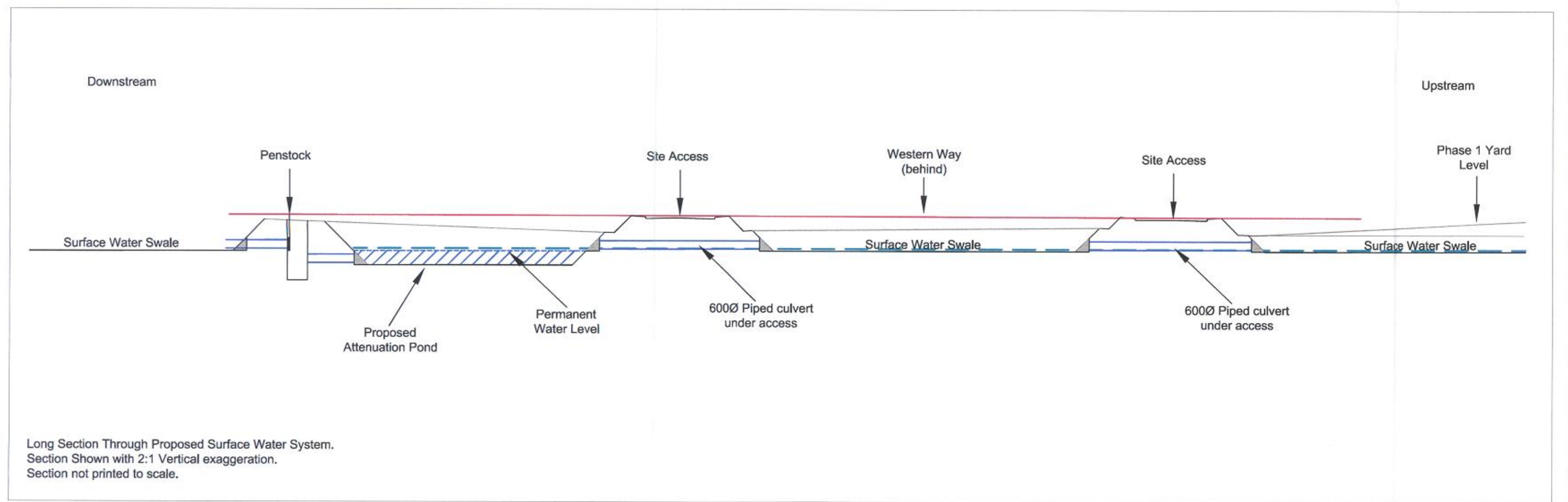

Long Section Through Proposed Surface Water System.
Section Shown with 2:1 Vertical exaggeration.
Section not printed to scale.

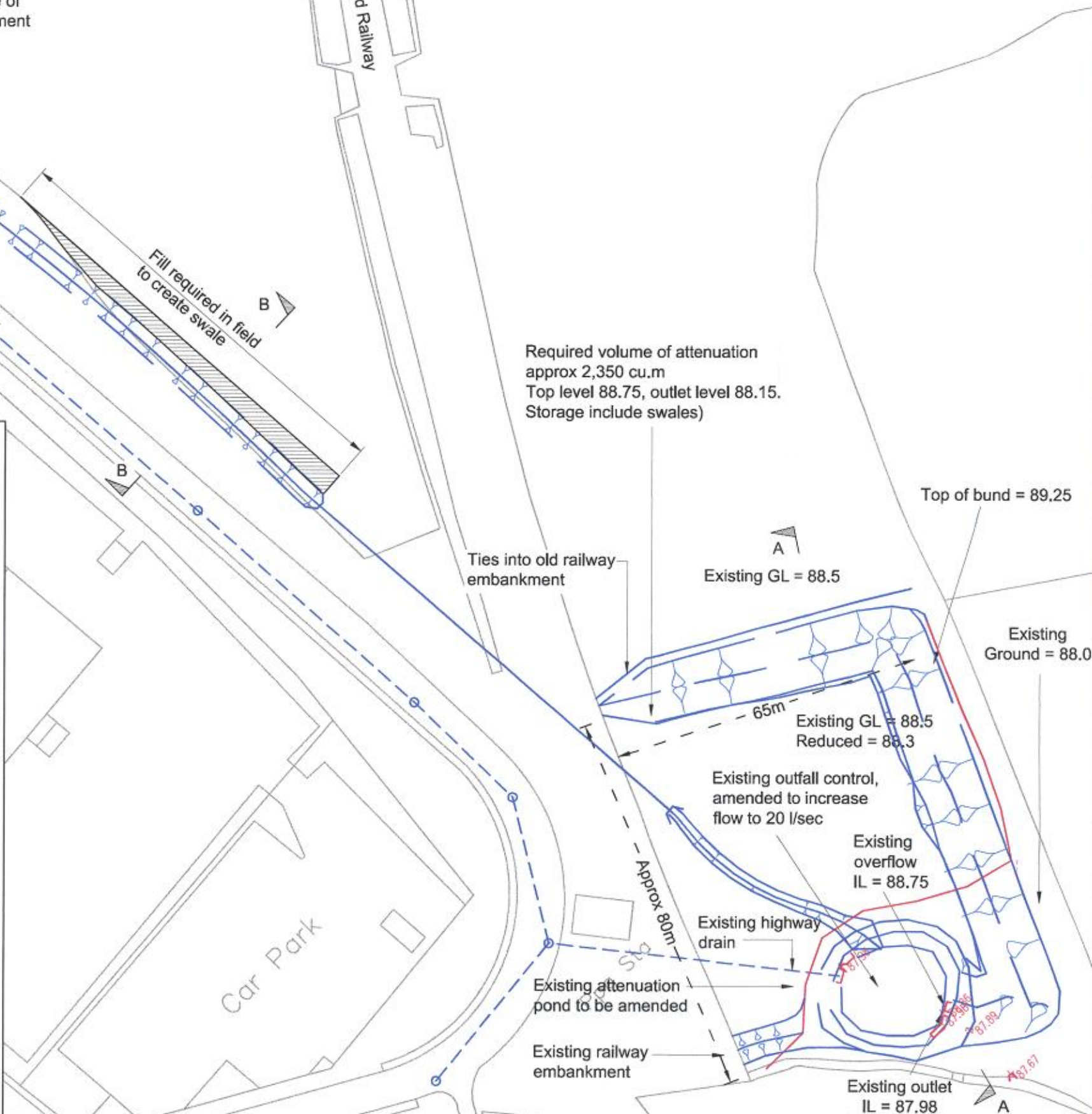

C	Plot sizes amended & swale relocated	YIW	NS	M.P
		01.04.14	01.04.14	01.04.14
B	Pond Design Amend	DM	NS	M.P
		18.09.2012	18.09.2012	18.09.2012
A	Planning Boundary added	YIW	NS	M.P
		20-07-12	20-07-12	20-07-12
Revision	Amendment	Originated by	Checked by	Approved by
		and date	and date	and date

mouchel
Haughton View, Silka Drive,
Shrewsbury Business Park Shrewsbury SY2 6LG
Tel: 01743 276300 Fax: 01743 276391
Web Site: www.mouchel.com

Client: **McPHILLIPS (WELLINGTON) LIMITED**
CIVIL ENGINEERS

Project: **Hales Sawmill**

Drawing Title: **Drainage Details for Planning Application**

Drawn By: DM 28.03.2012	Checked By: NS 28.03.2012	Approved By: MP 28.03.2012	Scale: (at A1 size) 1:1000
----------------------------	------------------------------	-------------------------------	-------------------------------

Purpose: **Preliminary** Draft Issue

Drawing Number: **1044364-P-500** Revision: **C**